

FLAT ROOF BOARD



Flat Roof Board is an unfaced stone wool board, that is utilized for the thermal insulation, sound insulation and fire safety of all kinds of flat roofs.

Application

İzocam Stone Wool Flat Roof Boards are used for thermal insulation, sound insulation and fire safety purposes under waterproofing. One layer of nylon cover is laid on corrugated metal roofing sheet as a vapour barrier. It is overlapped at the seams by 10 cm. and adhered to the surface. According to thermal insulation thickness, one or two layers of İzocam Stone Wool Flat Roof Board are laid on vapour barrier layer by fastening to the corrugated metal cover with anchors which have large washers. It is recommended to alternate board seams when two layer application is preferred. On top of that, waterproofing membrane (bituminous membrane, pvc, tpo, etc.) is applied.

Thickness (cm)	Width x Length (cm)	Package (m ²)
3	60 x 120	5,76
4	60 x 120	4,32
5	60 x 120	3,60
6	60 x 120	2,88
8	60 x 120	2,16
10	60 x 120	1,44
12	60 x 120	1,44

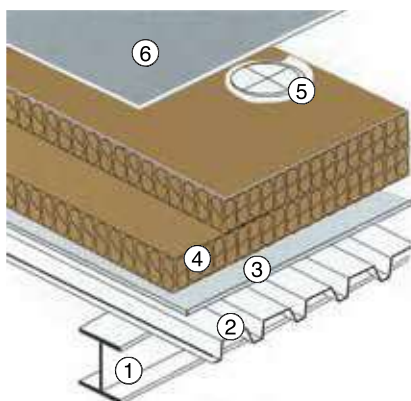

- Structural System ①
- İzocam Tekiz ②
- Corrugated Sheet
- Vapour Barrier ③
- Flat Roof Board ④
- Fastening Element ⑤
- Waterproofing ⑥

- Thermal insulation
- Fire safety
- Sound insulation
- Easy to apply
- Available in different sizes



TECHNICAL DATA SHEET

izocam Flat Roof Board

Properties		Symbol	Unit	Description							Tolerance	Standard
Material		-	-	Stone Wool							-	TS EN 13162
Density		ρ	kg/m ³	150							+/-10%	-
Width		w	mm	600							+/-1,5%	TS EN 822
Length		l	mm	1200							+/-2%	TS EN 822
Facing		-	-	Unfaced							-	-
Thickness	Unfaced	t	mm	30	40	50	60	80	100	120	T4 *	TS EN 823
Reaction to fire		-	-	A1							-	TS EN 13501-1
Declared Thermal Conductivity (10 °C)		λ_D	W/mK	0,039							-	TS EN 12667 / 12939
Thermal Resistance		R _D	m ² .K/W	0,75	1,00	1,25	1,50	2,05	2,55	3,05	-	TS EN 13162
Water Vapor Diffusion Resistance Coefficient **		μ	-	1							-	TS EN 12086
Compressive Strength		σ_{10}	kPa	25	40	55	65	75	85	100	-	TS EN 826
Short Term Water Absorption		W _p	kg/m ²	max. 1							-	TS EN 1609
Long Term Water Absorption		W _{lp}	kg/m ²	max. 3							-	TS EN 12087
Packaging Material		-	-	PE Film							-	-
Other Information		Yellow/black glass tissue and aluminium foil faced are available.										

* T4: -3% or -3 mm; +5% or +5 mm. The biggest value is chosen at minus tolerance, the smallest value is chosen at plus tolerance.

** Literature value.

Safety Reminders for Loading, Unloading, Shipping and Storing

- These operations should be done indoors if the weather is rainy.
- Loading and unloading should be done by (at least) two people.
- Products should be wrapped by a waterproof cover even if the shipping distance is short.
- Products should not be superposed with pallets.
- Products should not be put into upright position.
- Products should not be stepped on and should not be used as steps.
- Products should not be pulled by their package.
- Products should be in packages (10 each) and maximum 6 packages can be superposed.
- Before binding, hard cardboards (minimum 20 x 50 cm) should be put on the corners of packages to protect against possible damages by ropes.
- Storage area should be protected against any wet threats such as rain, float, etc. Indoor spaces should be preferred.
- The packages should be put on the floor with extra care so the corners of the product especially is not damaged by a hit.

Izocam is not responsible for any problem because of misprinting. Izocam, the manufacturer, reserves the right to alter product specifications without prior notice. Izocam also manufactures special products upon request. For your requirements, you are requested to contact our Export Department.

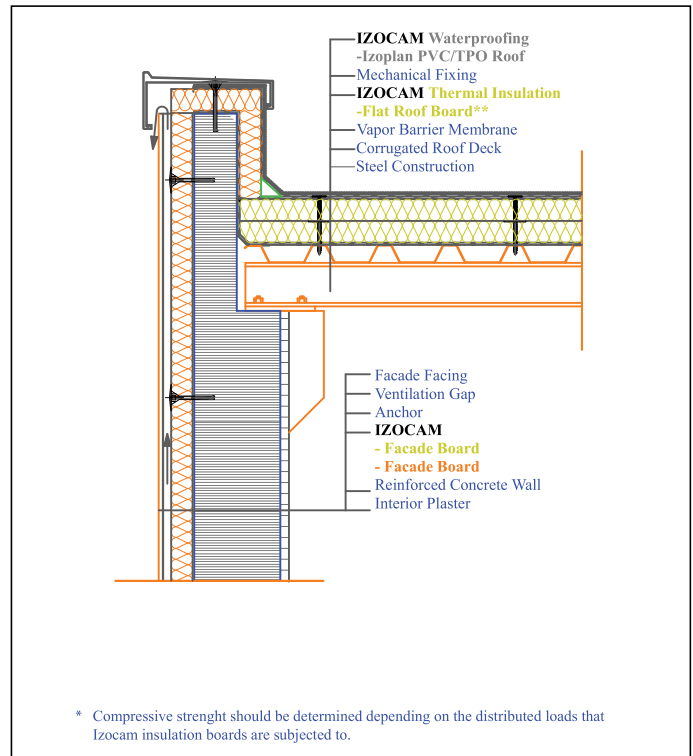

ENTYTCL2018/11



DECLARATION OF PERFORMANCE

N°: 3-CPR-2013/07/01-R2 (EN)

1. Unique identification code of the product-type:

IZOCAM STONEWOOL BOARDS (SW Board, SW Partition Wall Board, SW Partition Wall Board Eko, SW Facade Board, SW Floating Floor Board, SW Flat Roof Board , Manto SW, Manto SW R*,

2. Type, batch or serial number or any other element allowing identification of the construction product as required pursuant to Article 11(4):

(See product label)

3. Intended use (according harmonised technical specification) of the product:

Thermal insulation of Building

4. Name, registered trade name and contact address of the manufacturer:

*İzocam Ticaret ve Sanayi A.Ş.
Altayçeşme Mahallesi Çamlı Sok. Esas Ofispark No:21 Kat:4-5 Maltepe - İstanbul
www.izocam.com.tr*

5. Name and contact address of the authorised representative:

Not applicable

6. System(s) of Assessment and Verification of Constancy of Performance of the construction product:

*AVCP System 1 for Reaction to fire
AVCP System 3 for other characteristics*

7. Case a construction product covered by a harmonised standard:

TECHNICKÝ A ZKUŠEBNÍ ÚSTAV STAVEBNÍ PRAHA, (Notified Body n° 1020) and ERA Laboratuvarları A.Ş., (Notified Body n°2184) performed the determination of the product-type on the basis of type testing (including sampling); initial inspection of the manufacturing plant and of factory production control; continuous surveillance, assessment and evaluation of factory production control; under system 1 issued a certificate of constancy of performance No:1020-CPD-010030438.

TEBAR Test Belgelendirme Araştırma ve Geliştirme Tic. A.Ş., (Notified Body n°2164) performed the determination of the product-type on the basis of type testing (based on sampling carried out by the manufacturer), under system 3. Issued the relevant test reports.



9. Declared performance:

All characteristics listed in the table hereunder are determined in harmonised standard EN 13162:2012+A1:2015.

Essential characteristics	Performance	Harmonized Technical Specification
Thermal resistance	Thermal resistance R_D See Product Label	EN 13162:2012 + A1:2015
	Isil İletkenlik λ_D See Table 1	
	Thickness d_N See product label - T5 for Manto SW and Manto SW R* - T4 for other products	
Reaction to fire	Reaction to fire See Table 1	
Durability of reaction to fire against heat, weathering, ageing/degradation	Durability Characteristics See table 1	
Durability of thermal resistance against heat, weathering, ageing/degradation	Thermal Resistance R_D See product label	
	Thermal conductivity λ_D See Table 1	
	Durability Characteristics DS(70,90)	
Compressive strength	Compressive strength See table 1	
	Point Load NPD	
Tensile/flexural strength	Tensile strength perpendicular to faces -Manto SW ≥ 15 kPa -Manto SW R+ $\geq 7,5$ kPa - NPD for other products	
Durability of compressive strength against ageing/degradation	Compressive creep NPD	
Water permeability	Long and short term water absorption WS1 and WL(P)3 for - Manto SW - Manto SW R* - SW siding board - NPD for other products	
Water vapour permeability	Water vapour transmission and water vapour diffusion resistance factor NPD	
Impact noise transmission index (for floors)	Dynamic stiffness NPD	
	Thickness NPD	
	Compressibility NPD	
	Air flow resistivity NPD	
Acoustic absorption index	Sound absorption NPD	
Direct airborne sound insulation index	Air flow resistivity NPD	
Release of dangerous substances to the indoor environment	Release of dangerous substance NPD	
Continuous glowing combustion	Continuous glowing combustion NPD	
NPD : No Performance Determined.		



Table 1

Product	Facing	Density (Kg/m ³)	Thermal Conductivity (W/mK)	Compressive strength (kPa)	Reaction to Fire	
SW Partition Wall Board	Unfaced	$50 \leq \rho \leq 120$	0,035	NPD	A1	
SW Partition Wall Board Eko	Unfaced	$35 < \rho \leq 40$	0,038	NPD	A1	
SW Floating Floor Board	Unfaced	110	0,035	≥ 5	A1	
SW Flat Roof Board	Unfaced	$140 \leq \rho \leq 150$	0,039	25 for d=30 mm	A1	
				40 for d=40 mm		
				50 for d=50-60 mm		
				60 for d=70 mm		
				70 for d=80-90 mm		
				80 for d=100 mm		
100 for d \geq 110 mm						
Manto SW R*	Unfaced	$120 \leq \rho < 140$	0,037	Min.10 for d=30 mm Min.30 for d>30 mm	A1	
Manto SW	Unfaced	$140 \leq \rho \leq 150$	0,039	Min.25 for d=30 mm Min.40 for d>30 mm	A1	
SW Facade Board	Unfaced / Glass tissue / Alufoil (without kraft)	$50 \leq \rho \leq 120$	0,035	NPD	A1	
SW Facade Board	Alufoil (with kraft)	$50 \leq \rho \leq 120$	0,035	NPD	C-s1,d0	
SW Board	Unfaced	$35 \leq \rho$	0,039	NPD	A1	
		$35 < \rho < 40$	0,038			
		$40 < \rho < 50$	0,037			
	Unfaced / Glass tissue / Alufoil (without kraft)	$50 \leq \rho \leq 120$	0,035		A1	
		Alufoil (with kraft)	$50 \leq \rho \leq 120$		0,035	C-s1,d0
			Unfaced		$120 < \rho \leq 130$	0,037
	Unfaced	$130 < \rho < 140$	0,038		A1	
	Unfaced	$140 < \rho \leq 150$	0,039		A1	
	Unfaced	$150 < \rho$	0,040		A1	

9. The performance of the product identified in points 1 and 2 is in conformity with the declared performance in point 9. This declaration of performance is issued under the sole responsibility of the manufacturer identified in point 4.

Osman Hakan Uslu
R&D and Quality Assurance Manager
21/06/2019